

13. Now it is time to store the numbers that were determined in the pre-install checklist.

- Enter password 000 followed by [PROG]
- Press [PROG] multiple times until "MEMORY" icon flashes on LCD.
- Press [ARM/DISARM] to confirm.
- Press [\* /UP] or [# /DOWN] buttons until you are at memory location 1.
- Enter the 1st phone number (make sure to enter as 1-XXX-XXX-XXXX).
- Press [ARM/DISARM] to confirm.
- Press [ARM/DISARM] to get into the memory mode again.
- Press [\* /UP] or [# /DOWN] buttons until you are at memory location 2.
- Enter the 2nd phone number (make sure to enter as 1-XXX-XXX-XXXX).
- Press [ARM/DISARM] to confirm.
- Repeat previous four steps for all remaining phone numbers.
- Press [PROG] multiple times to get out of setup mode.

14. This CDU is now configured. Now you must Arm the system and you are finished. Please remember that if the system is not in "ARM" mode it will not work.

- Enter password 000 followed by [ARM/DISARM] to Arm CDU.
- 3 short beeps will sound and "ARM" will appear on LCD.
- Wait 60 seconds for a single beep. The CDU is now fully armed.

### Protector DataDispatch Post-Install Check List:

1. Inform those on your CDU call list that you have put them on the call list.
2. Look through the supplemental Owner's Manual to learn more about this system, including how to use the CDU with other wireless sensors for doors, windows, and motion.
3. Remember that **"ARM" must appear on the LCD for the system to work.** If "ARM" is not showing on the LCD it will not work.
4. Read about the Low Battery indicators in the Owner's Manual (p.6) and make sure to check from time to time. If the battery in the Wireless Sensor goes out, the system WILL NOT WORK.
5. Tell others how great your new Protector DataDispatch is and send them to [www.floodnot.com](http://www.floodnot.com).

### What happens when the Protector DataDispatch detects high water.

Upon high water, the CDU (if armed) will beep and display "Trigger" and zone "1". It will then dial the programmed phone numbers. While listening to the message on your phone, you can press "00" (wait for 2 beeps), then "20002" to discontinue the notification calls to all additional numbers. If you do not press the code to discontinue before the message ends, the CDU will call the next phone number in line. If notification is not discontinued by users of any of the programmed phone numbers, you will be called again as many times as you entered in setup. Each time you are called, you have the opportunity to discontinue the process.

When the dialing is complete, the CDU will continue to flash "Trigger" and zone "1" until the password is entered. Enter 000 and Arm/Disarm. The unit will stop flashing the messages and is now disarmed. REMEMBER TO ARM THE UNIT AGAIN so it is ready for the next high water event.

**IMPORTANT NOTICE: Neither Basement Flood Protector nor any of its resellers or installers implies or accepts any liability or responsibility for the use of this product as an early warning device, theft, security, or deterrence system, or any losses resulting from successes or failures of the device to operate as expected. Device is sold strictly for information purposes only.**



707 Rose Road, Lake Zurich, IL 60047  
847-438-6770 800-238-0822  
[www.floodnot.com](http://www.floodnot.com)



Sensor activated alerts

This guide will provide the necessary information to set up The Protector DataDispatch wireless sump level sensor system. If desired, The Protector DataDispatch can be used as a whole house alert system, including sensors for windows, doors, motion, temperature, etc. For more detailed information and additional features such as off site remote control "Arm/Disarm", "Room Monitor" and "Broadcast" Features, Low Battery Indicator, etc, please also read the included document titled "Wireless Security/ Safety Alarm System With Auto Dialer Owners Manual".

**IMPORTANT NOTICE: Neither Basement Flood Protector nor any of its resellers or installers implies or accepts any liability or responsibility for the use of this product as an early warning device, theft, security, or deterrence system, or any losses resulting from successes or failures of the device to operate as expected. Device is sold strictly for information purposes only.**

### Included Components:

- 1 Central Dialing Unit (CDU)
- 1 Wireless Water Level Sensor
- 2 9v Batteries
- Mounting Hardware
- Instructions

### Pre-Install Check List:

1. Locate sump pump and make sure that an area on the PVC discharge pipe is accessible to mount sensor.
2. Locate area to put Central Dialing Unit (CDU). Keep within 50 feet of sump pit. CDU can be mounted to wall or set on a table, desk, counter, etc. CDU comes with 6 feet of phone line. If you want it farther than 6 feet from your phone jack you will need a longer phone line or extension cord.

3. Write down up to 5 phone numbers that CDU will call in case of a failure:

Name:	Phone Number:
1 _____	_____
2 _____	_____
3 _____	_____
4 _____	_____
5 _____	_____

4. Circle number of times for CDU to call each phone number. Default setting is 3.

1 2 3 4 5

5. Write down the 20-second message to record. It is best to keep it short and repeat a few times until 20 seconds are used up. *Example:* "This is the sump pump DataDispatch, press xx to discontinue dialing. This is the sump pump DataDispatch, press xx to discontinue dialing. This is the sump pump DataDispatch, press xx to discontinue dialing." (xx is a password you choose later.)

---

---

**Note: If this unit is being used as a whole house alert system, wording should be modified. Ex: "This is your DataDispatch home alert system, press xx to discontinue dialing..."**

6. You will need a small Phillips screwdriver to remove battery covers. If installing to a wall you will need a drill and drill bits. It is assumed installer has a cell phone to do a few test calls while installing system.

### DataDispatch CDU and Wireless Sensor Installation Instructions:

1. Install 9-volt batteries in CDU and Wireless Sensor (this requires a small Phillips screwdriver).
2. Mount CDU to wall or set on a table, desk, counter, etc. Plug antenna into side of CDU. Plug phone line in LINE jack on CDU and phone jack other end in to working jack on wall. Plug AC Adapter into CDU and into electrical outlet.

3. Program CDU to recognize Wireless Sensor. To Learn Wireless Sensor ID Code:
  - Enter password 000 followed by [PROG].
  - Press [PROG] multiple times until "LEARN" icon flashes on LCD.
  - Press [ARM/DISARM] to confirm, the system will now be ready for ID code setup and zone 1 icon will flash.
  - Press [\* /UP] or [# /DOWN] buttons until you are at zone 1 and "NO ID CODE" is displayed on LCD.
  - Press [ARM/DISARM] to confirm.
  - Trigger float switch on wireless sensor. You will hear a long beep confirming code was learned successfully and LCD will display "FULL".
  - Press [\* /UP] or [# /DOWN] to get out of this mode.
  - Press [PROG] multiple times to get out of setup mode.
4. Record 20-second message to be played back by CDU that you wrote out on pre-install checklist:
  - Enter password 000 followed by [REC./PLAY] button once.
  - Speak your message into CDU until it plays message back.
  - Press [REC./PLAY] to hear it played back again if desired.
5. Program the Call-In Ring Detect Cycle to be set for 10 times. This ensures that CDU does not interfere with an answering machine. If there is no answering machine skip this step.
  - Enter password 000 followed by [PROG]
  - Press [PROG] multiple times until "🔔" icon flashes on LCD.
  - Press [ARM/DISARM] to confirm.
  - Press [\* /UP] or [# /DOWN] buttons until you are at the number 10.
  - Press [ARM/DISARM] to confirm.
  - Press [PROG] multiple times to get out of setup mode.
6. Program the number of times for CDU to call each phone number as determined in the pre-install checklist. If using the default dialing Cycle of 3 you can skip this step.
  - Enter password 000 followed by [PROG].
  - Press [PROG] multiple times until "CYCLE" icon flashes on LCD.
  - Press [ARM/DISARM ] to confirm.
  - Press [\* /UP] or [# /DOWN] buttons to select 1-5 calls to each phone number.
  - Press [ARM/DISARM] to confirm.
  - Press [PROG] multiple times to get out of setup mode.
7. Program Entry Delay Time to 0 seconds (*note*: if CDU will be used as whole house alert, do not set delay to 0 seconds).
  - Enter password 000 followed by [PROG].
  - Press [PROG] multiple times until "ENTRY" icon flashes on LCD.
  - Press [ARM/DISARM] to confirm.
  - Press [\* /UP] or [# /DOWN ] buttons until you get to 0.
  - Press [ARM/DISARM] to confirm.
  - Press [PROG] multiple times to get out of setup mode.

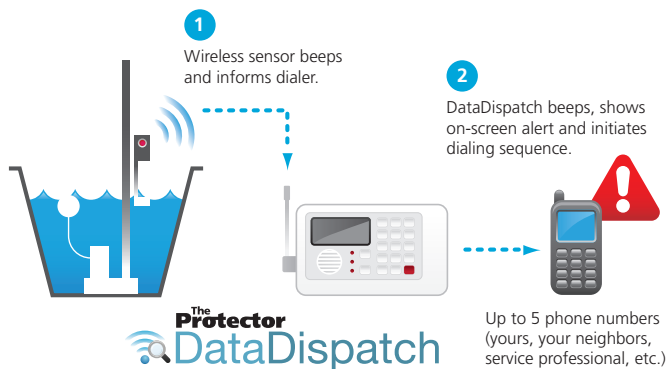

8. Enter in the date and time in the Real Time Setting.
  - Enter password 000 followed by [PROG].
  - Press [PROG] multiple times until "🕒" icon flashes on LCD.
  - Press [ARM/DISARM] to confirm.
  - The date will show in the LCD as five sets of numbers, year-month-day, hour-minute. The first set of numbers will flash confirming that these can now be changed.
  - Press [\* /UP] or [# /DOWN] buttons to select the correct date and time followed by the [ARM/DISARM] to confirm each number and store. You will now have correct date and time.
  - Press [PROG] multiple times to get out of setup mode.
9. Test that CDU and Wireless Sensor are working by doing a test call to your cell phone.
  - Enter password 000 followed by [PROG].
  - Press [PROG] multiple times until "MEMORY" icon flashes on LCD.
  - Press [ARM/DISARM] to confirm.
  - Press [\* /UP] or [# /DOWN] buttons until you are at memory location 1.
  - Enter your cell phone number (Make sure to enter each number as dialed from your home phone, e.g., 1-XXX-XXX-XXXX for long distance, 9-1-XXX-XXX-XXXX for business calls to outside lines).
  - Press [ARM/DISARM] to confirm.
  - Press [PROG] multiple times to get out of setup mode.

You will now get ready to trip the sensor. Please keep in mind the CDU will sound an alarm that is **very loud**.

- Enter password 000 followed by (ARM/DISARM) to Arm CDU.
  - 3 short beeps will sound and "ARM" will appear on LCD.
  - Wait 60 seconds for a single beep. The CDU is now fully armed.
  - Move the float switch on Wireless Sensor. The alarm will sound and you will get a call on your cell phone playing back your message. Hold your hand over the speaker while doing this to quiet the alarm.
  - Now that basic functionality has been confirmed, enter password 000 followed by [ARM/DISARM] to Disarm the CDU.
10. Attach float switch to the bracket. Use 2 nylon ties to affix the float switch to the waste pipe at a point higher than where water level rises when sump pump is properly working. Switch the Wireless Sensor to "Alarm On". Mount the float sensor to wall close to sump pit. Do not mount wireless sensor to waste pipe as vibrations tend to make the electronics fail.
  11. Test that CDU and Wireless Sensor are working by doing a test call to your cell phone for a second time. This ensures that everything is properly hooked up and that the Wireless Sensor is within range of CDU.
    - Enter password 000 followed by [ARM/DISARM] to Arm CDU.
    - 3 short beeps will sound and "ARM" will appear on LCD.
    - Wait 60 seconds for a single beep. The CDU is now fully armed.
    - Move the float switch on Wireless Sensor. The alarm will sound and you will get a call on your cell phone playing back your message. Hold your hand over the speaker while doing this to quiet the alarm.
    - Enter password 000 followed by [ARM/DISARM] to Disarm the CDU and to stop it from calling your phone and turn alarm off.
  12. Now that you have determined that everything is working properly it is time to finish configuring the system. Now you will delete the test phone number, unless it is also the first number you wish to be called. If so skip this step.
    - Enter password 000 followed by [PROG].
    - Press [PROG] multiple times until "MEMORY" icon flashes on LCD.
    - Press [ARM/DISARM] to confirm.
    - Press [\* /UP] or [# /DOWN] buttons until you are at the test phone number to delete.
    - Press the [DEL./PAUSE] button to delete the test phone number.
    - Press [ARM/DISARM] to confirm.
    - Press [PROG] multiple times to get out of setup mode.